

abbotFox



Norwich, NR6

Guide Price £120,000

“

We are a team of genuine individuals who hold a deep passion for both property and marketing. Collectively, we bring over 70 years of experience in the property market of Norfolk and Suffolk. Our affection for both counties runs deep, and we are enthusiastic about sharing our passion with you.

Colin McKenzie | **Branch Partner**







THE DETAIL _____

abbotFox presents a fully renovated one bedroom ground floor flat located within the popular suburb of Hellesdon. The property features an entrance hall, double bedroom, sitting room, modern kitchen with integral appliances and a modern family bathroom. The property also benefits from a new heating system and carpets throughout.

Guide price £120,000 - £130,000

THE HIGHLIGHTS _____

- Ground floor flat
- One double bedroom
- Modern fitted kitchen
- Sitting room
- Modern bathroom
- Ideal first time buy
- No onward chain

Approx Gross Internal Area
38 sq m / 411 sq ft

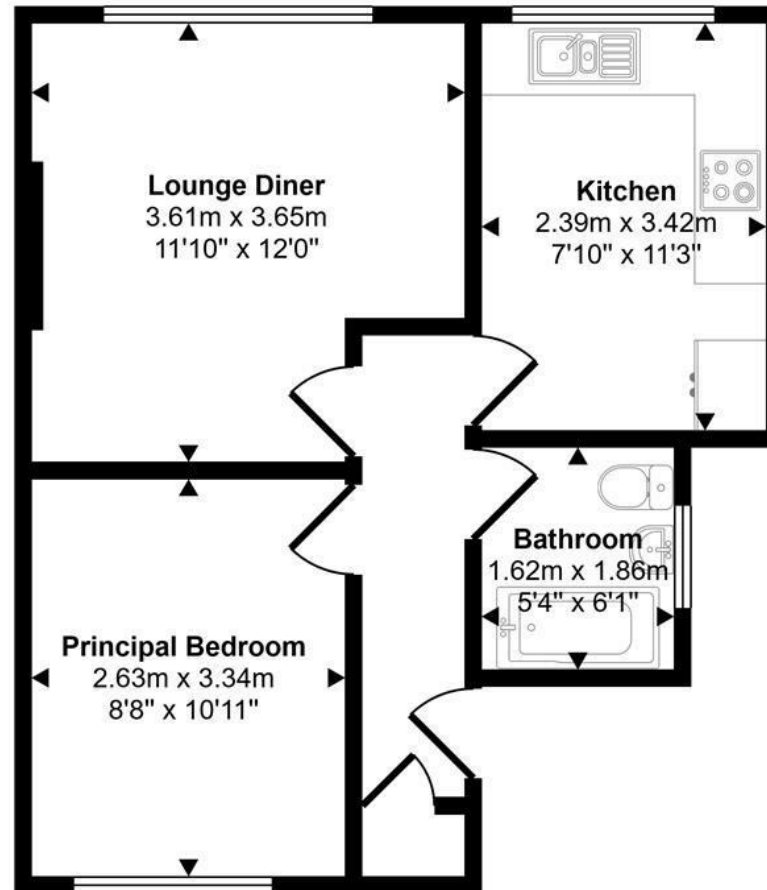

Floorplan

This floorplan is only for illustrative purposes and is not to scale. Measurements of rooms, doors, windows, and any items are approximate and no responsibility is taken for any error, omission or mis-statement. Icons of items such as bathroom suites are representations only and may not look like the real items. Made with Made Snappy 360.

Let's talk

01603 660000

sales@abbotfox.co.uk

@abbotfox

EPC RATING -

Disclaimer – In accordance with the Property Misdescriptions Act, the company abbotFox gives notice that all descriptions, references to condition, necessary permissions for use and other details are given in good faith and believed to be correct, but any purchaser should not rely on them as statements of fact, and must satisfy themselves by inspection or other means, as to their accuracy.